



# HID ontstekers

## Versions



GPPR SI 0001

## Maatschets

▽

| Product                | D1     | C1      | A1      | A2      | B1      |
|------------------------|--------|---------|---------|---------|---------|
| SI 51 220-240V 50/60Hz | 4,3 mm | 38,0 mm | 84,5 mm | 65,0 mm | 41,0 mm |

▽

| Product             | D1     | C1      | A1       | A2      | B1      |
|---------------------|--------|---------|----------|---------|---------|
| SND 88 400V 50/60Hz | 4,3 mm | 38,5 mm | 114,5 mm | 95,0 mm | 41,5 mm |

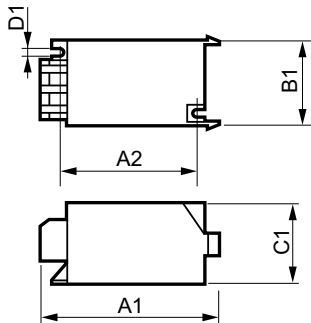

| Product                 | D1     | C1      | A1      | A2      | B1      |
|-------------------------|--------|---------|---------|---------|---------|
| SND 57 220-240V 50/60Hz | 4,3 mm | 38,5 mm | 84,5 mm | 65,0 mm | 41,5 mm |
| SND 58 220-240V 50/60Hz | 4,3 mm | 38,5 mm | 84,5 mm | 65,0 mm | 41,5 mm |

# HID ontstekers

## Productgegevens



SND 88 & 89

### Bedrijfs- en elektrische gegevens

Ingangsfrequentie 50 tot 60 Hz

### Bedrijfs- en elektrische gegevens

| Order Code | Full Product Name       | Ingangsspanning |
|------------|-------------------------|-----------------|
| 93066830   | SND 57 220-240V 50/60HZ | 220 tot 240 V   |
| 93068230   | SND 58 220-240V 50/60HZ | 220 tot 240 V   |

| Order Code | Full Product Name      | Ingangsspanning |
|------------|------------------------|-----------------|
| 91034940   | SND 88 400V 50/60HZ    | 400 V           |
| 91553530   | SI 51 220-240V 50/60HZ | 220 tot 240 V   |

### Eigenschappen behuizing en afmetingen

| Order Code | Full Product Name       | Behuizing |
|------------|-------------------------|-----------|
| 93066830   | SND 57 220-240V 50/60HZ | SNI-85    |
| 93068230   | SND 58 220-240V 50/60HZ | SNI-85    |

| Order Code | Full Product Name      | Behuizing |
|------------|------------------------|-----------|
| 91034940   | SND 88 400V 50/60HZ    | SNI-115   |
| 91553530   | SI 51 220-240V 50/60HZ | SNI-85    |

